

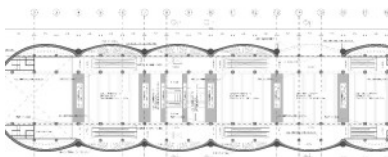

GLOBAL PROJECT OF THE LINE 2 AND AV. FAUCETT - AV GAMBETTA

TENDER PROJECT FOR 35 METRO STATIONS - DESIGN OF INTERNAL STRUCTURES, AUXILIARY STRUCTURES AND EARTH RETAINING STRUCTURES

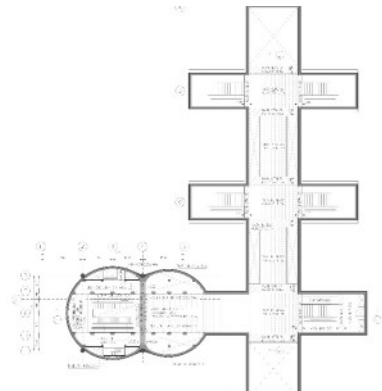

Client: Consortium Metro de Lima Línea 2; CJC – Engenharia e Projetos Ltda.

Location: Primary Subway Network of Lima and Callao - Peru

Design date: 2013 - 2014

Services: Tender Project for 35 metro stations - Design of internal structures, auxiliary structures and earth retaining structures

Summary:

Structures basic design for 35 new metro stations, divided into 9 types. 27 passenger stations will be on line 2 (length 27 km) and 8 stations will be built on the branch Av Faucett - Av Gambetta (7.6 km long)

Constructive methods considered in the study included Vertical NATM excavation (vertical tangent shafts) and Cut-and-cover. The design and modelling were developed based on detailed seismic studies of soil-structure interaction using seismograms of large earthquakes in Chile and Peru.

[SEE ONLINE](#)