

GALIZA STATION

PRELIMINARY STAGE, CONCEPT AND EXECUTIVE DESIGN - STRUCTURAL ENGINEERING

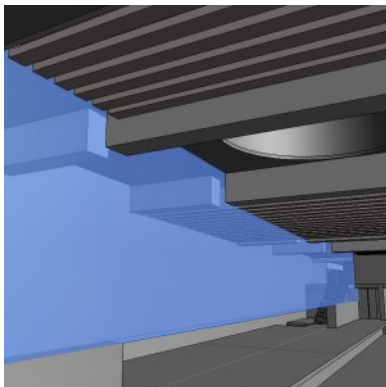
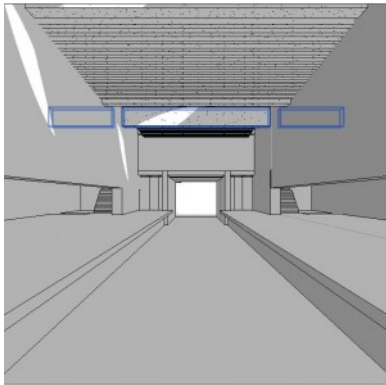

Client: Metro do Porto – Project Division

Location: Porto, Portugal

Design date: 2018 - 2019

Design by: Daniel P. Sousa / Pedro B. Carvalho

Services: Preliminary Stage, Concept and Executive Design - Structural Engineering

Summary:

Galiza Station is composed by its main building and 4 surface accesses.

It is located in a heavily conditioned area due to the crossing of Ribeira de Massarelos that crosses Galiza Square in an underground gallery, the existing roadways and the Sophia Garden classified as a municipal heritage interest, as well as the various residential buildings and services located in the surrounding area, along with the technical requirements for future connection to the planned Campo Alegre Line station.

Galiza Station is excavated in Cut & Cover under the containment with tangent pile curtain. Galiza station occupies a total deployment area of 5,985 m² and a gross building area of 17,900 m² corresponding to 5 different levels and has a total volume of 60 200 m³. It is estimated that the new line will be used on average by about 28,000 passengers / day.

[SEE ONLINE](#)